

Air Bricks

Air bricks are the multi-vent bricks that most houses contain to allow air to circulate in the building. They are usually 15cm or so off the ground, and surround the house at that level.

These are obviously an issue with flood water, and need blocking in those circumstances. FloodworksPro supply a range of air bricks & also covers which can be attached quickly and easily in case of a flood.

We offer the product in two sizes which reflect the most common air brick sizes, but if you have a variation on this, then let us know as custom sizes are also available

Airbricks in Action

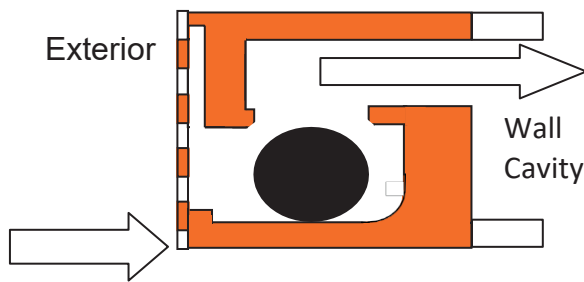

Normal Conditions

The Airbrick is a straight replacement for a standard airbrick allowing free airflow under the floorboards eliminating the risk of damp and dry rot and stopping rodent infestation.

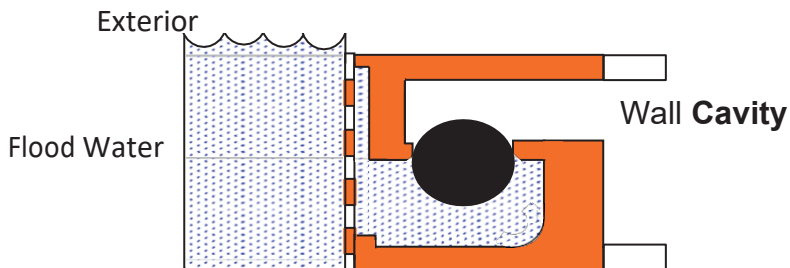

Flood Conditions

The Airbrick uses a simple floatation valve to automatically shut off during flood conditions. 4 valve balls float on the floodwater automatically stopping the flow of water under the property.

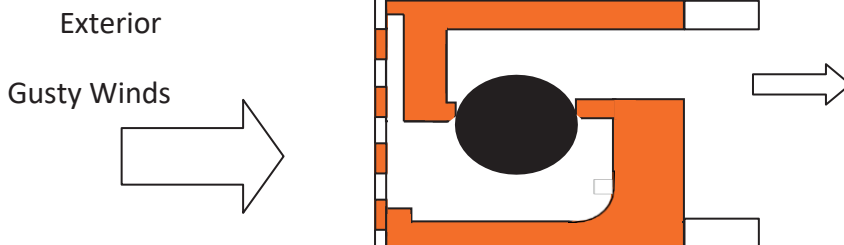

Very Windy Conditions

The Airbrick utilises its aerodynamic design to automatically shut off during strong gusty winds. This stops heat loss from under the property saving money on your heating bills.
An energy saving device.